

Flexible Workplace, Elevated.

Welcome to the future.

You can now change your environment like you change tabs on a web browser. Walls float and move with the rhythms of activity.

Workplaces are smaller, but better. They're where we build connections and innovate together. They're agile and ready to adapt in a rapidly changing world.



mixed signals from remote work

are we tuning in or losing connection?

For some, remote working is a productive commute-free utopia with less distractions and the flexible schedule of their dreams.

For others, working from home means cramped quarters, loneliness despite endless video calls, and the loss of work-life balance.

Listening to people with compassion and reason, it's clear that we don't all function the same way and shouldn't be expected to.

The ideal environment for great work is different depending on the person and the tasks of the day. We can work with our human nature, not against it.

After a year of improvised kitchen counter conferences, sofa social hours, and even bathroom brainstorms, the last thing on our wish list is to return to a static office space.

As virtual tools enable new possibilities, our physical workspaces can't stay stuck in the past, based on outdated notions of productivity.

For innovation, we need deeper connections, healthier habits, and earned trust. These are developed through shared experiences in a variety of circumstances.

The workplace of the future isn't just one place. The spaces we inhabit have to adapt along with us.



**the concept of
workplace is
evolving before
our eyes**



No one wants to be stuck in an office anymore. But they are desperate for rich engaging experiences, to connect with colleagues, and to advance their careers.

With remote work as the new norm, many people will only occasionally travel in to the office. Let's make those visits occasions to remember.

Each day, the workplace will have to support a different mix of people, teams, and visitors.

To create workplaces as flexible as we are, a new type of adaptable design element is needed - something that allows spaces to transform in real time.

active partitions designed for change

Flat Move is a design tool that enables new ways of flexible space planning.

Movable modules join together to create agile arrangements that are so much more than just walls.

We look at the white space in between. Flat Move dynamically creates the variety of spaces that workers crave: meeting rooms, work lounges, huddle spaces, private nooks.

Architects, designers, and workplace experts can define numerous uses for a single workspace, while allowing for spontaneous adaptations by the people working there.

The various environments that Flat Move enables are far from static. They easily change as needed, depending on the team and their evolving interactions. Building interiors can change over time without additional material waste from construction.

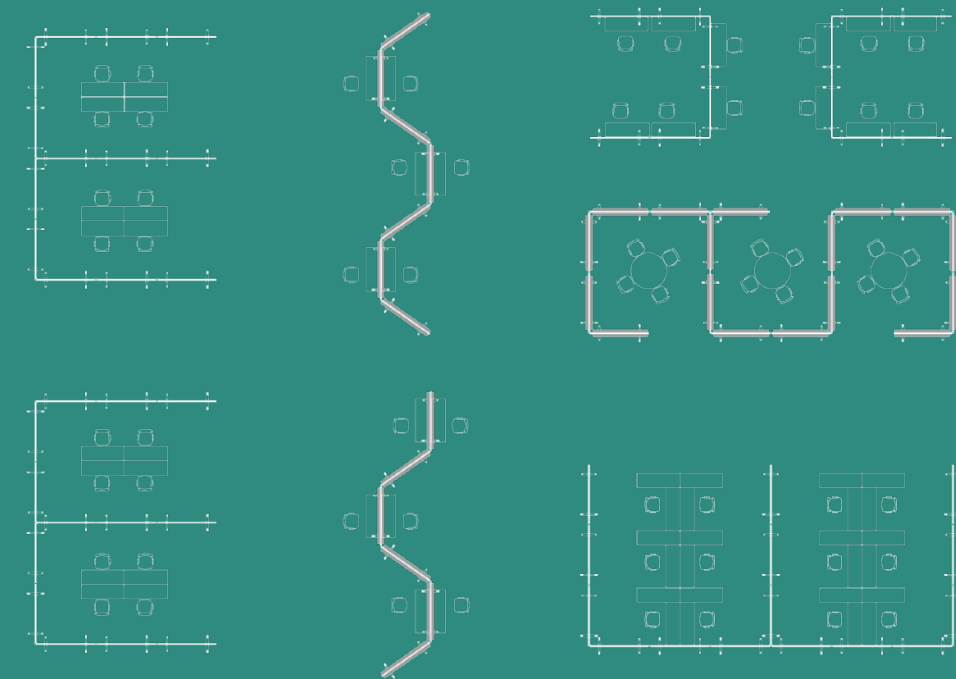
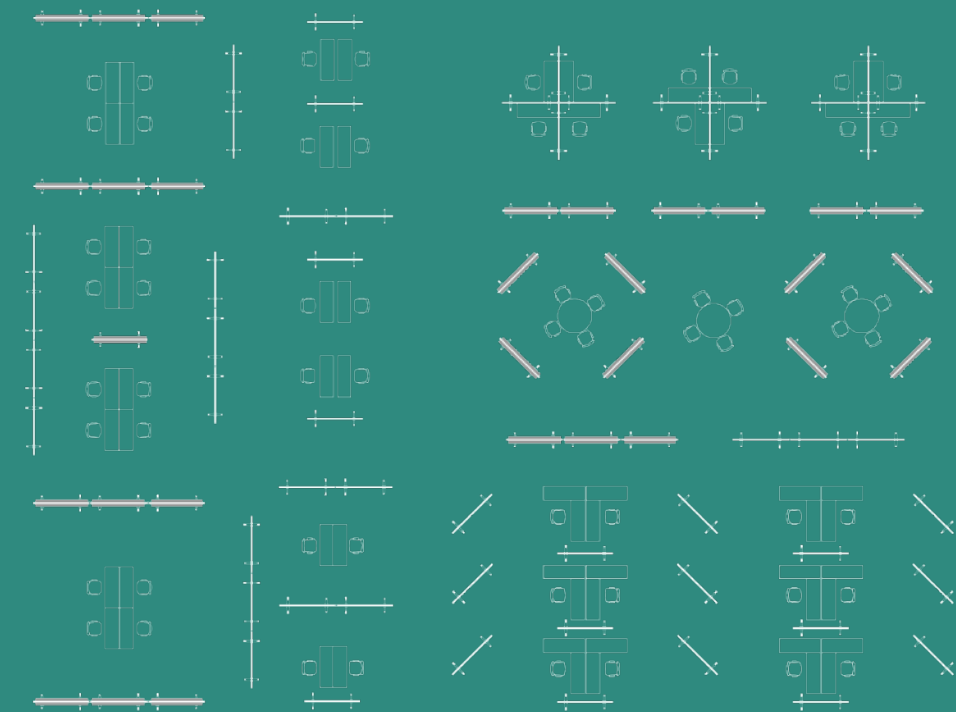

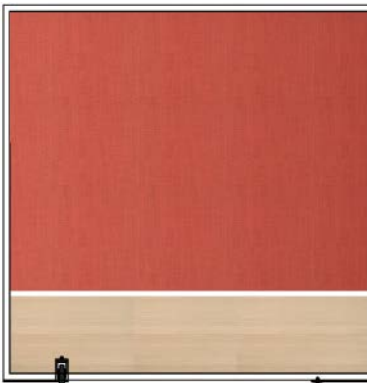
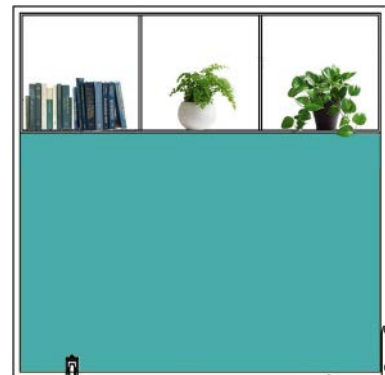
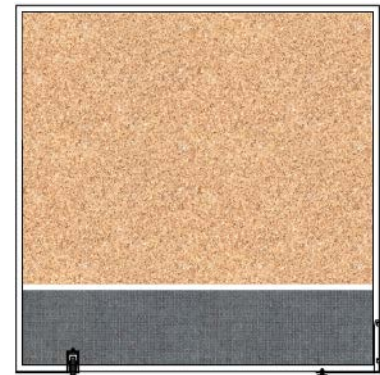

The only barrier to Flat Move is your imagination.

Flat Move modules are built on a fully customizable framework for **limitless design choices**.

From decorative glass to full shelves and planters, Flat Move is a blank canvas for you to work with.

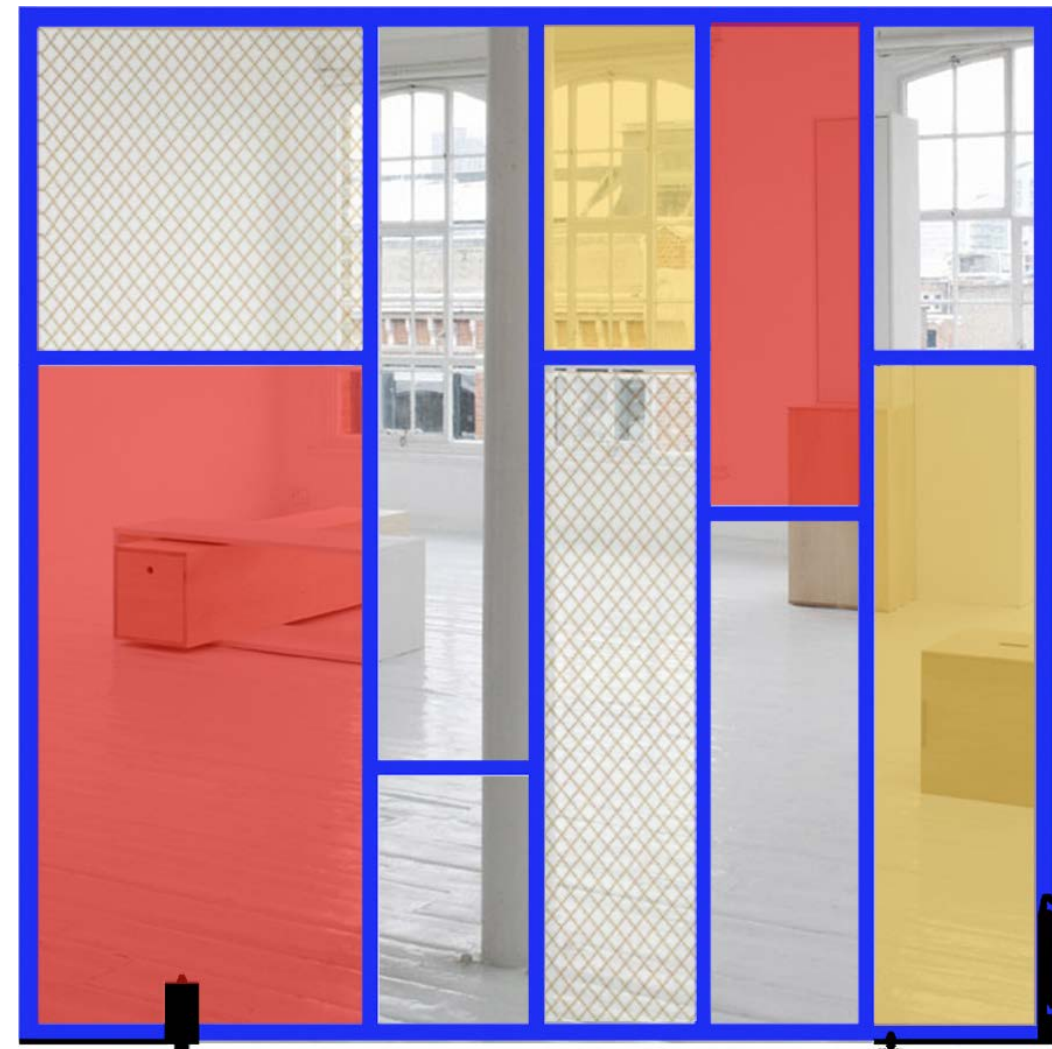

< Just a few ideas to get you started



Maximize the vertical workspace and get people thinking on their feet in a healthy way.

Flat Move interactive features bring people together to foster collaboration, innovation and teamwork – the hardest things to do virtually are the exact things that generate lasting competitive advantage, and that make work fun.

If it's not for working together, **what's the office of the future for?**



Flat Move | Manufactured and engineered by Flat by Artis.

hello@habitatmatter.com
habitatmatter.com/flatmove



HABITAT
MATTER