

IMPACT ACOUSTIC®

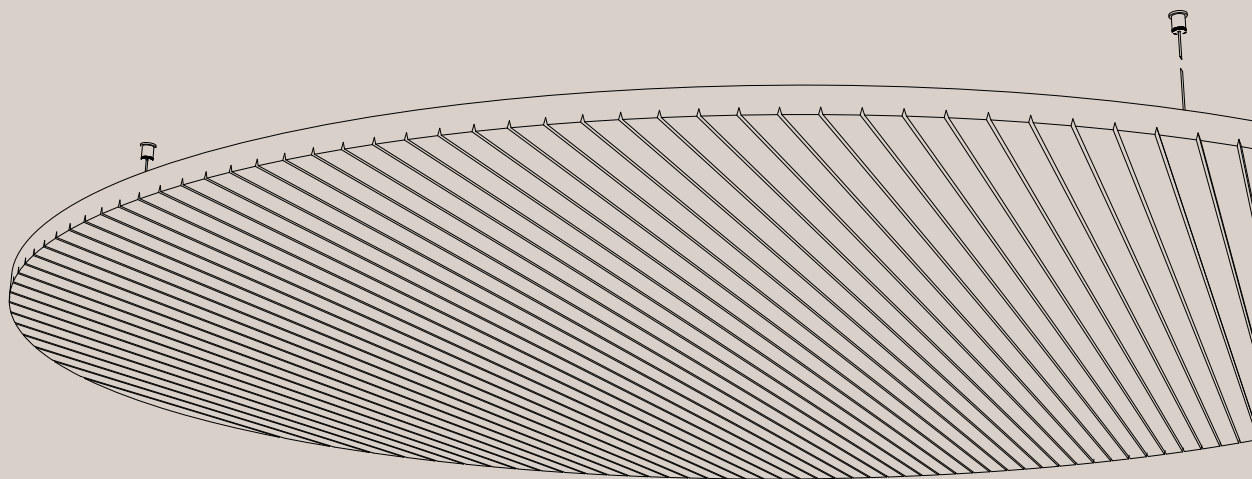

**HABITAT
MATTER**

habitatmatter.com
spec@habitatmatter.com



Vertigo Fine Ceiling Panel

711.24.18.000.60

711.24.17.000.60

711.24.25.000.60

TECHNICAL DATA SHEET

Vertigo Fine

Ceiling Panel

Article number

711.24.18.000.60

Dimensions

| | | |
|-----------|--------|--------|
| Length | 1800mm | 70.86" |
| Width | 1800mm | 70.86" |
| Thickness | 24mm | 0.94" |

Information

1 pc., incl. installation kit

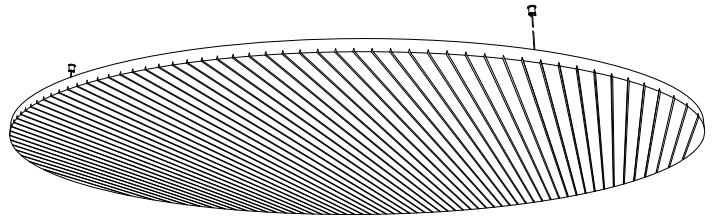

Front

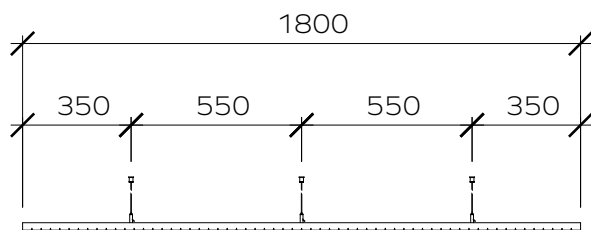

V-cut Detail

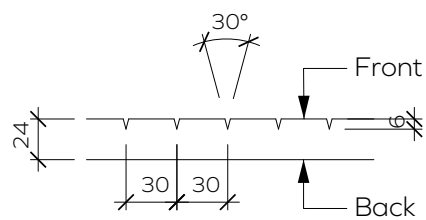

Plan

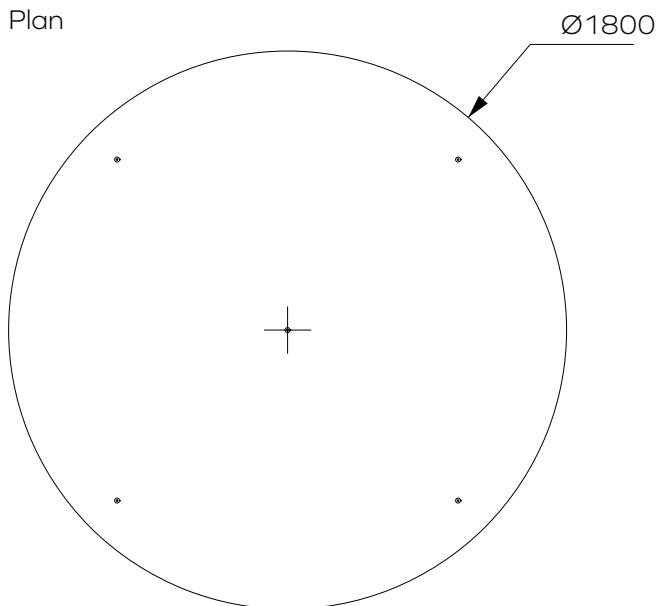

Suspension Kit - Direct

Vertigo Fine Ceiling Panel

Article number

711.24.17.000.60

Dimensions

| | | |
|-----------|--------|--------|
| Length | 1200mm | 47.24" |
| Width | 1200mm | 47.24" |
| Thickness | 24mm | 0.94" |

Information

1 pc., incl. installation kit

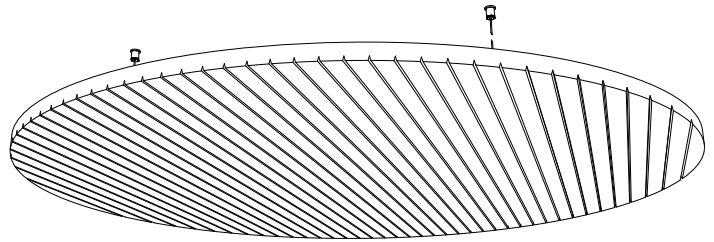

Front

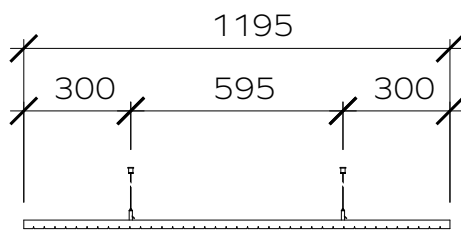

V-cut Detail

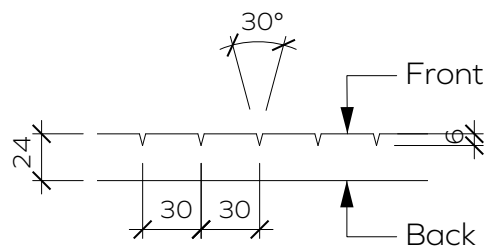

Plan

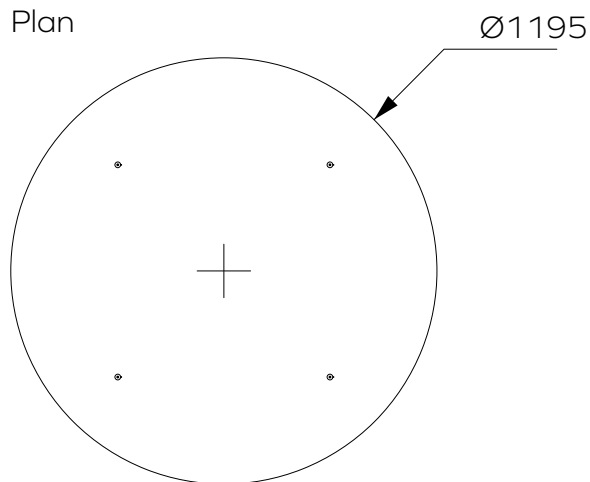

Suspension Kit - Direct

Vertigo Fine Ceiling Panel

Article number

711.24.25.000.60

Dimensions

| | | |
|-----------|-------|--------|
| Length | 800mm | 31.50" |
| Width | 800mm | 31.50" |
| Thickness | 24mm | 0.94" |

Information

1 pc., incl. installation kit

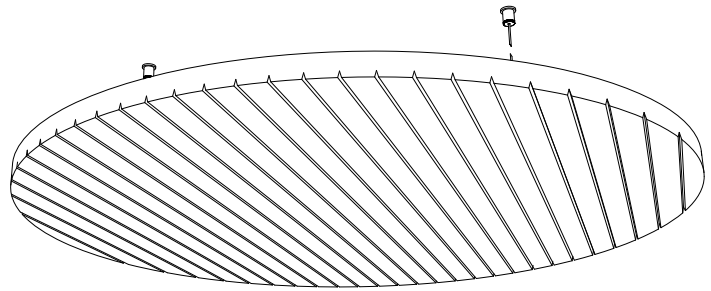

Front

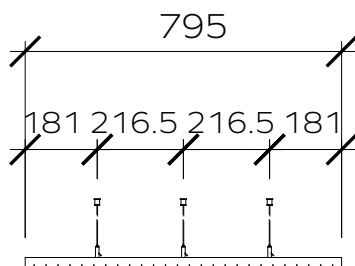

V-cut Detail

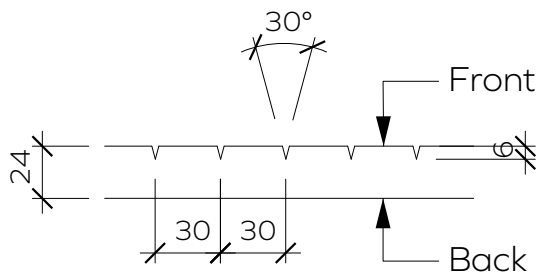

Plan

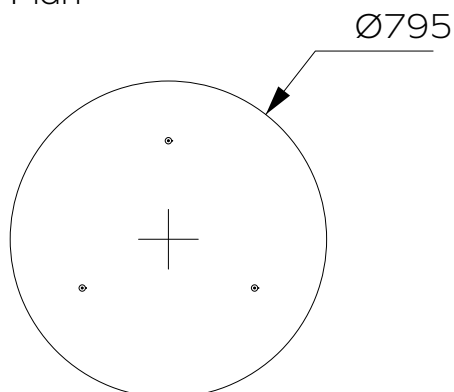

Suspension Kit - Direct

Vertigo Fine Ceiling Panel



HABITAT
MATTER
habitatmatter.com
spec@habitatmatter.com

Acoustic Technical Specifications

Vertigo Fine Ceiling Panel 24mm

| Frequency (Hz) | 125 | 250 | 500 | 1000 | 2000 | 4000 |
|--|------|------|------|------|------|------|
| Vertigo Fine Ceiling Panel Round (D800mm) | 0.20 | 0.35 | 0.44 | 0.65 | 0.75 | 0.79 |
| Vertigo Fine Ceiling Panel Round (D1200mm) | 0.44 | 0.78 | 1.01 | 1.47 | 1.70 | 1.80 |
| Vertigo Fine Ceiling Panel Round (D1800mm) | 0.99 | 1.75 | 2.29 | 3.30 | 3.81 | 4.06 |

Sound Absorption Coefficient (α_s) according to EN ISO 354
Universität Stuttgart – Institut für Akustik und Bauphysik IABP



University of Stuttgart
Germany

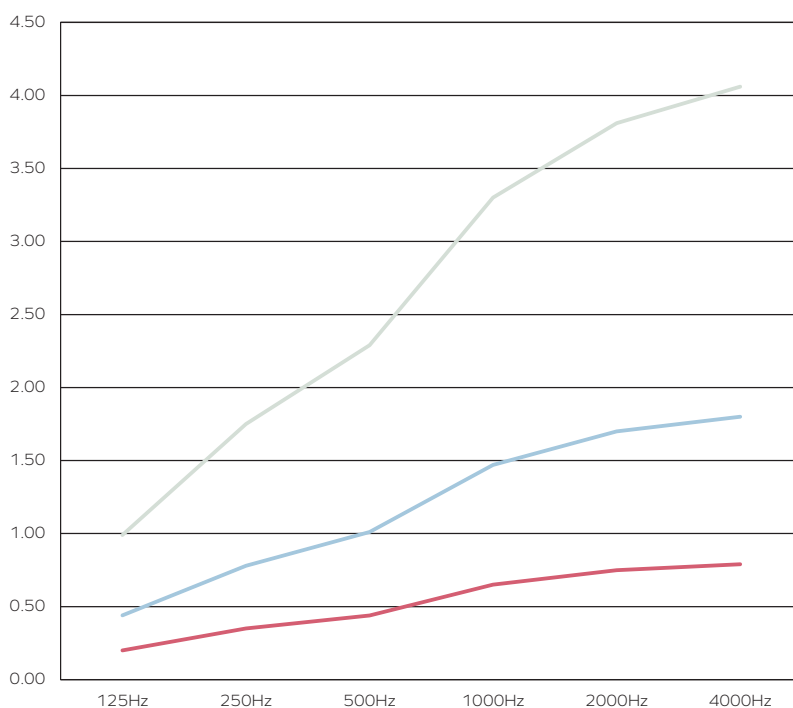

***“If you want to control
room acoustics from the
ceiling, keep one
important principle in
mind: size matters.”***

– Daniel Verlooven,
Global Acoustic Ambassador

- Vertigo Fine Ceiling Panel 24mm - D800mm
- Vertigo Fine Ceiling Panel 24mm - D1200mm
- Vertigo Fine Ceiling Panel 24mm - D1800mm

The graph represents the sound absorption coefficients (α_s) in the third octave band center frequencies. Measurement used Pink Noise as excitation signal in a reverberant room.

ARCHISONIC®

Colours

Quiet Neutrals

12mm & 24 mm

These shades work in harmony with natural textural materials and soften industrial environments. From light to dark and cool to warm, these are the foundations of any scheme where longevity and a mood of calm is desired.



Warm Naturals

12mm & 24 mm

Combinations of lighter toned neutrals and pinks have a gently soothing and restorative effect while the more saturated hues make perfect environments for relaxation.



ARCHISONIC®

Colours

Living Greens

12mm & 24 mm

From the cool greens of forests to the yellowed aspect of young wheat, we see Living Greens breathing life into indoor spaces, and an essential palette for the future. Use in tonal layers brings the depth and diversity of green, while a single note can provide an amplifying backdrop to a biophilic space.

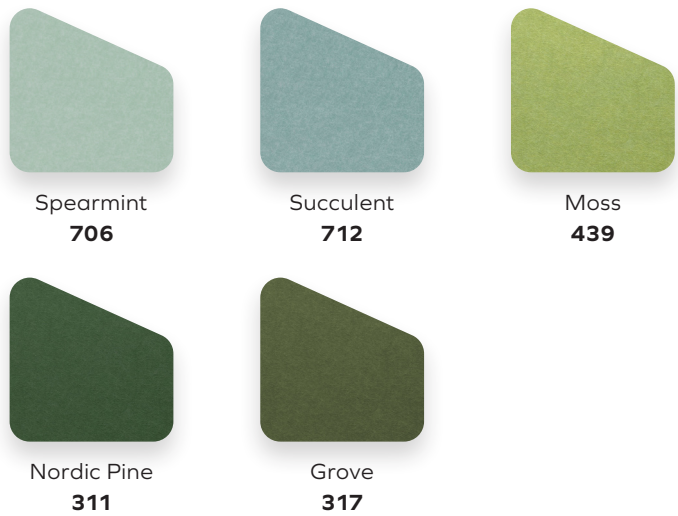

Elemental Blues

12mm & 24 mm

These blues work perfectly both as familiar single hues and in effortless tonal layers to create an immersive environment for focus or restoration.

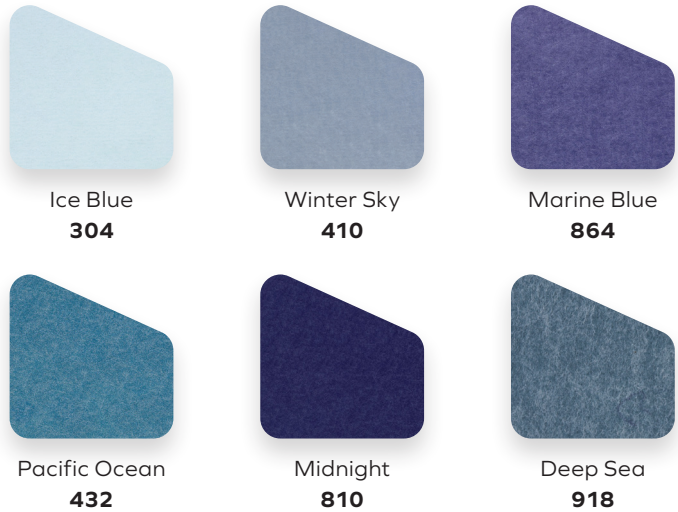

ARCHISONIC®

Colours

Soothing Pastels

12mm & 24 mm

With tonal duos of pink and blue and green, this perfectly balanced group is designed for peaceful plays on light and shade and playful contrast. While the lightest tones have a dreamlike quality, their deeper counterparts add a subtle grounding.



Shell Pink
102



Soft Coral
516



Ice Blue
304



Winter Sky
410



Spearment
706



Succulent
712

Elegant Darks

12mm & 24 mm

While colour can create a mood, it is the depth or lightness of a hue that truly defines the emotion. While each hue has the strength to stand alone, beautiful effects can be achieved with harmonized pairs.



Garnet
724



Marine Blue
864



Midnight
810



Nordic Pine
311



Raven
550

ARCHISONIC®

Colours

Energetic Brights

12mm & 24 mm

There are no rules here with endless possibilities for clashing contrasts or surprising highlights. For a sophisticated use of energetic colour, take a single hue and colour match contrasting textiles and solid surfaces.



Pacific Ocean
432



Moss
439



Sunshine
846



Electric Orange
464



Hot Pink
140

Primary Play

12mm & 24 mm

The primary story happens when all three main colours are used together, with varied proportions creating differing moods. As with the Energetic Brights palette, combine with coordinating-coloured textiles and solid surfaces.



Snow White
500



Charcoal
542



Sunshine
846



Poster Red
662



Marine Blue
864



ARCHISONIC® Material



HABITAT
MATTER

habitatmatter.com
spec@habitatmatter.com

Composition

100% PET (60% certified post-consumer content)

Material Reutilisation

24mm

88 PET bottles/m²

12mm

53 PET bottles/m²

Density

24mm

4000 g/m² (+/-10%)

12mm

2400 g/m² (+/-10%)

Dimensions Raw Panels

24mm

1800 x 2400 x 24mm

70" x 94" x 0.94" (+/-7%)

12mm

1200 x 2800 x 12mm

47" x 110" x 0.47" (+/-7%)

Fire Test

B-s1, d0

DIN EN 13501-1

Class A

ASTM E84

VOC Emission

A+

28 Days French Regulation

Pass

14 Days CDPH/EHLB



Care Instructions

PET fibres do not provide a breeding ground for bacteria and other germs. The dyed-through fibres do not bleach out even when using aggressive cleaning agents and disinfectants. Alcohols, aldehydes or active chlorine can be used for cleaning.

For daily cleaning we recommend alcohol solution (75%), e.g. Pantasept. In case of contamination by dust or fluff, use feather duster or a regular vacuum cleaner. For heavy dirt, treat the material with hydrogen peroxide.

Declare.

ARCHISONIC®
Impact Acoustic AG

Final Assembly: Lucerne, Switzerland

Life Expectancy: 30 Year(s)

End of Life Options: Salvageable/Reusable in its Entirety, Take Back Program, Recyclable (98.5%)

Ingredients:

PET: Polyethylene Terephthalate; **Phosphorus flame retardant:** Phosphorus; **N, N'-Ethylene bis(stearamide):** Octadecanamide, N,N'-1,2-ethanediylbis-; **Stearic acid:** Stearic Acid; **Titanium dioxide:** Titanium dioxide

Living Building Challenge Criteria: Compliant

I-13 Red List:

☒ LBC Red List Free % Disclosed: 100% at 100ppm
☐ LBC Red List Approved VOC Content: Not Applicable
☐ Declared

I-10 Interior Performance: CDPH Standard Method v1.2-2017

I-14 Responsible Sourcing: Not Applicable

IMA-0001
EXP. 01 AUG 2023
Original Issue Date: 2022

MANUFACTURER RESPONSIBLE FOR LABEL ACCURACY
INTERNATIONAL LIVING FUTURE INSTITUTE™ living-future.org/declare



HABITAT
MATTER

habitatmatter.com
spec@habitatmatter.com

#We MakeAn Impact

connect@impactacoustic.com | www.impactacoustic.swiss