

IMPACT ACOUSTIC®

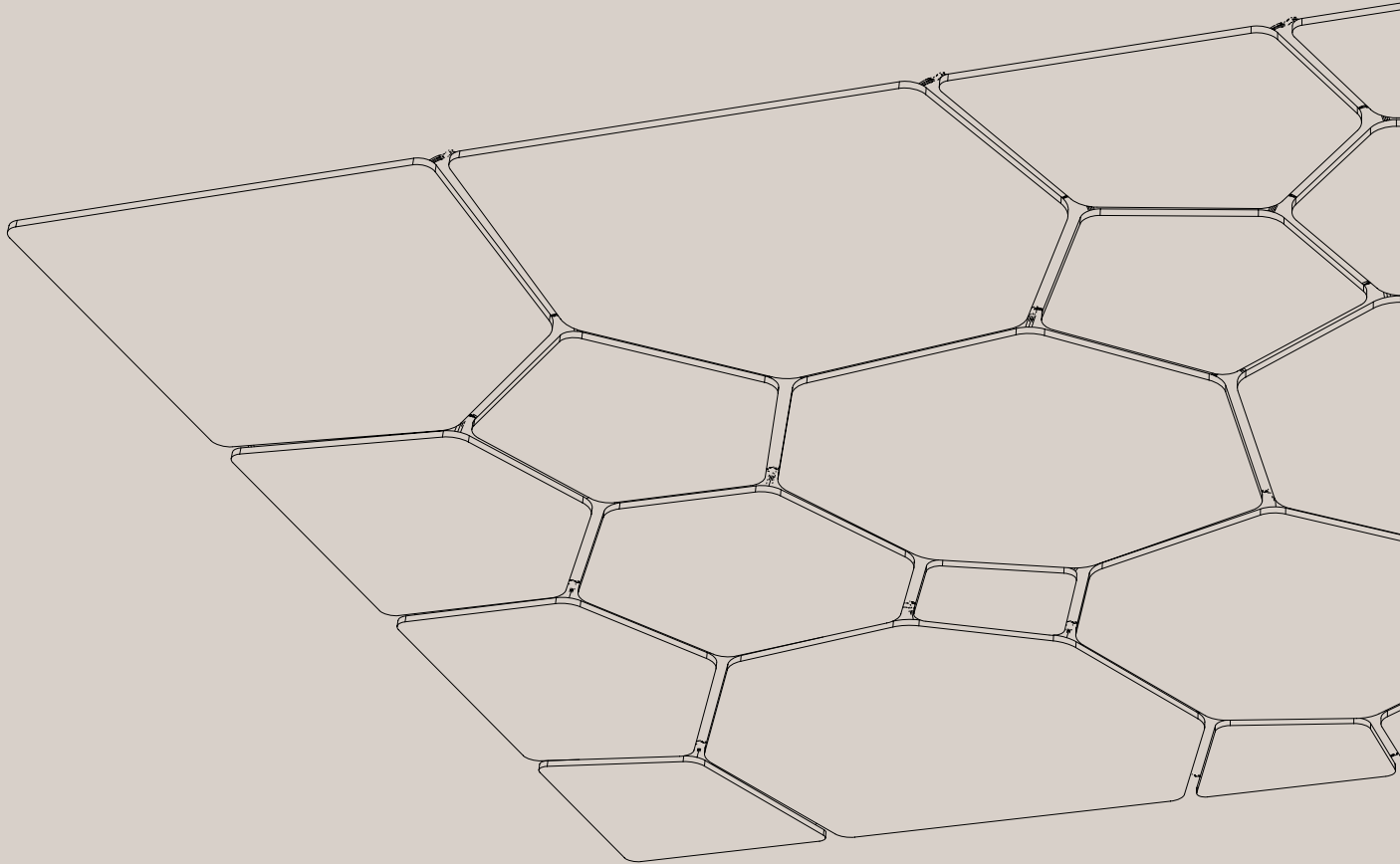

HABITAT
MATTER

habitatmatter.com
spec@habitatmatter.com



Plateau

Ceiling Systems

714.24.10.000.00

TECHNICAL DATA SHEET



HABITAT
MATTER

habitatmatter.com
spec@habitatmatter.com

Plateau Ceiling System

General Information



Data

Applicable article numbers

714.24.10.000.00

Dimensions¹

Length *on request*

Width *on request*

Material thickness 24mm 0.94"

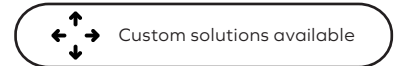

Material

Panles 100% PET (60% post-consumer) in 32 colors.

Mounting System Aluminium (powder coated black)

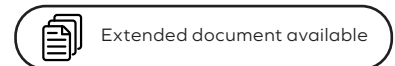

Weight²

Panels 4kg/m² (±10%) 0.82 lbs/ft² (±10%)

Included

Ceiling panels

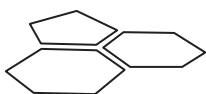

Suspension system



Spot lights *(on request)*



Installation guide



Design revision

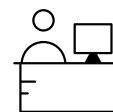

Warranty 2 years³



1 - all dimentions are nominal 2 - all weight values are nominal 3 - Impact Acoustic warranty terms apply



Plateau Ceiling System Specification Guide

Ensure you make the perfect choice by choosing our solutions for your next project. To get started, simply define some basic information and constraints about your space. Then explore our range of standard solutions or contact us directly for a more in-depth discussion of personalised customized options.

1 Prepare this information:

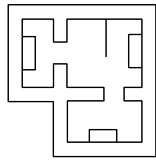

Project Area

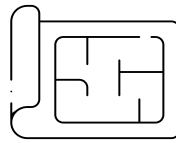

Ceiling Plans (RCP)

page 8

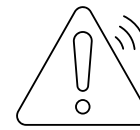

Other Considerations

page 8

2 Specify your options:

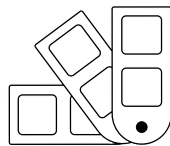

Color

page 8

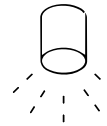

Lights

page 7

Plateau Ceiling System

Geometry Information

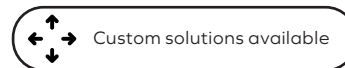

Reference geometry

Plateau system is a highly customizable bespoke ceiling acoustic solution. Our design team is able to create variety of solutions to fit any particular space requirements you might have, thus no two single applications of Plateau system will be the same - contact us for more details.

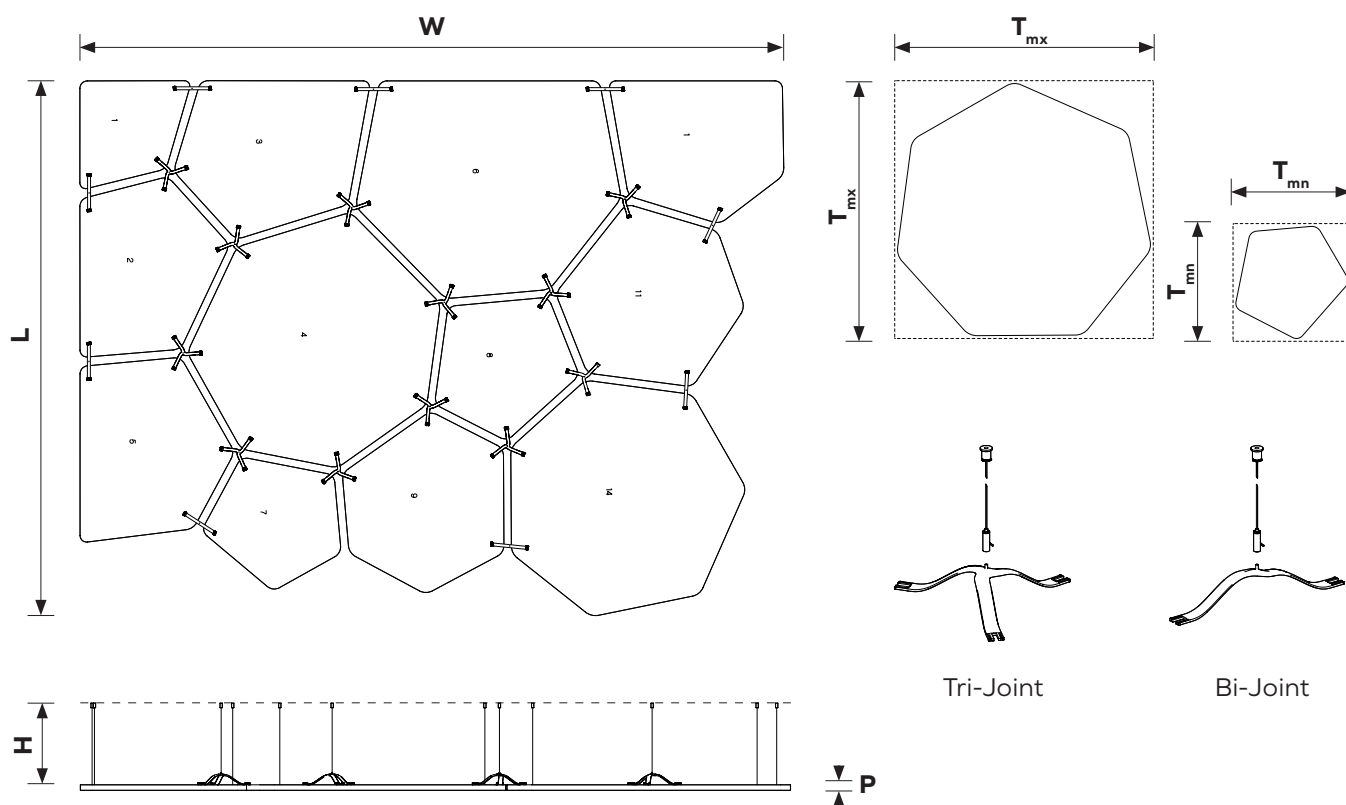

Dimensions table

W	Total width	on demand	on demand	<i>bespoke</i>
L	Total length	on demand	on demand	<i>bespoke</i>
T_{mx}	Panel max size	1800mm	70.87"	<i>maximum</i>
T_{mn}	Panel min size	800mm	31.50"	<i>recommended min.</i>
H	Distance from ceiling	150-1400mm	5.90"-55.12"	<i>adjustable range.</i>
P	PET material thickness	24mm	0.94"	



Plateau Ceiling System

Planning Considerations



Extended document available

When planning the addition of a Plateau Ceiling System to your space, please consider the following aspects.

1 Project area

Check and verify the project area where the Plateau System will be installed. This will allow us to provide you with an accurate quote.

If possible provide RCP drawings. This will help plan for any obstacles like columns and air-ducts that might collide with the Plateau.

2 Integrated light

Plan for proper light conditions in the space. You can easily implement our optional LED spot light (1) solution in selected panels. We recommend performing a light analysis for your space in order to specify the right quantity and location of spot light elements. See more on page 7.

3 Additional considerations

Consider access to high windows and doors.

Verify the type of material to which the support elements will be mounted. Plateau is using point-wire mounting system. See more on page 6.

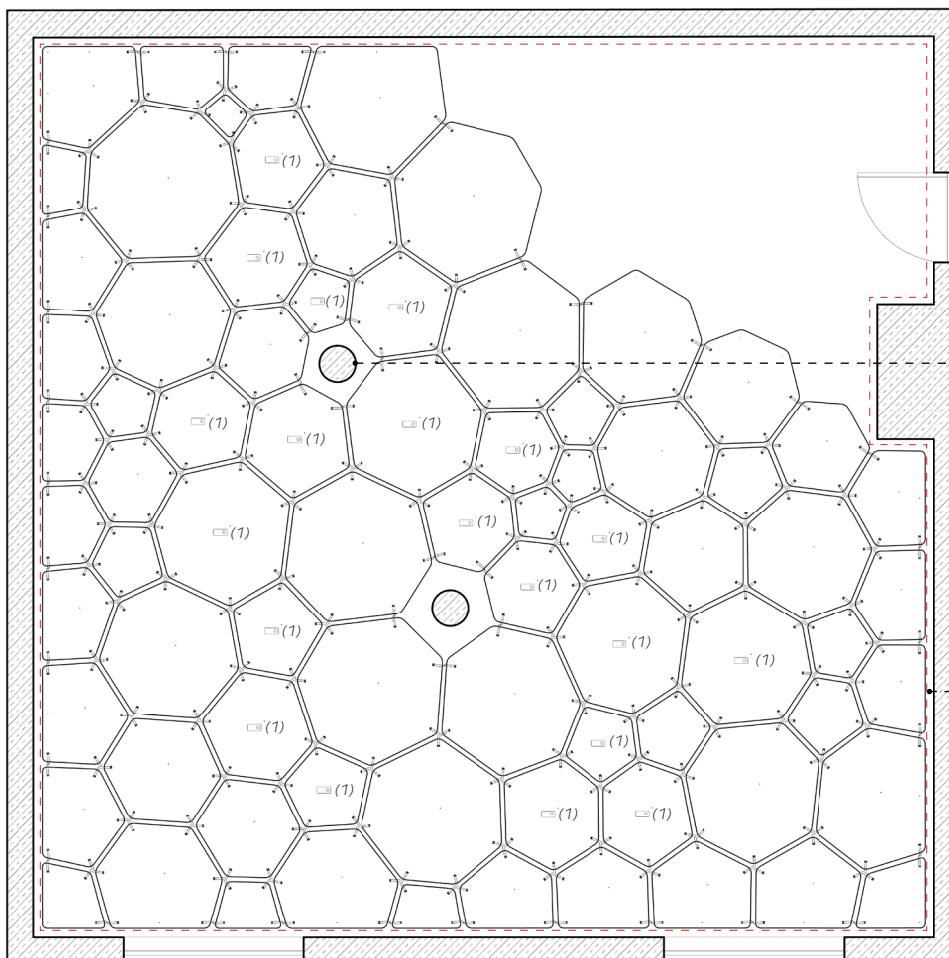

Consider position of columns and other vertical elements in the space. Plateau can be easily adjusted to accommodate for those.

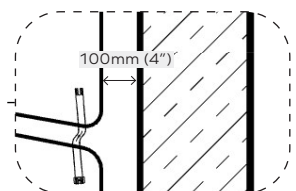
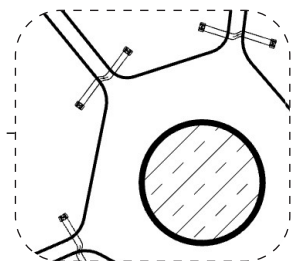

Plan for providing min. 100mm (4") safe space distance from panels to other elements



Plateau Ceiling System

Installation Overview



Extended document available

1 Verify and organize

Verify all delivered elements and organize them based on the included labeling and provided cardboard plans.

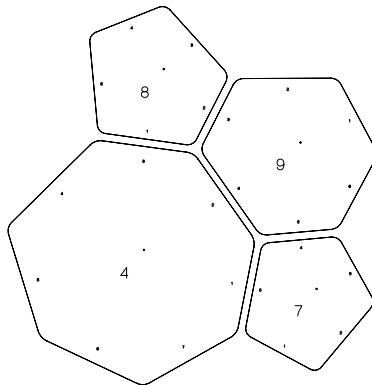

2 Fix hardware to ceiling

Use a vertical laser level to mark the locations of all suspension points on the ceiling. Fix hardware to ceiling on all marked suspension points as per the shop drawing.

3 Attach additional hardware to the panels

Fix hardware to the marked side of the panels. Align clips to rectangular markings and attach with screw (A). Screw in the double sided gripper screws in a position of circular markings (B).

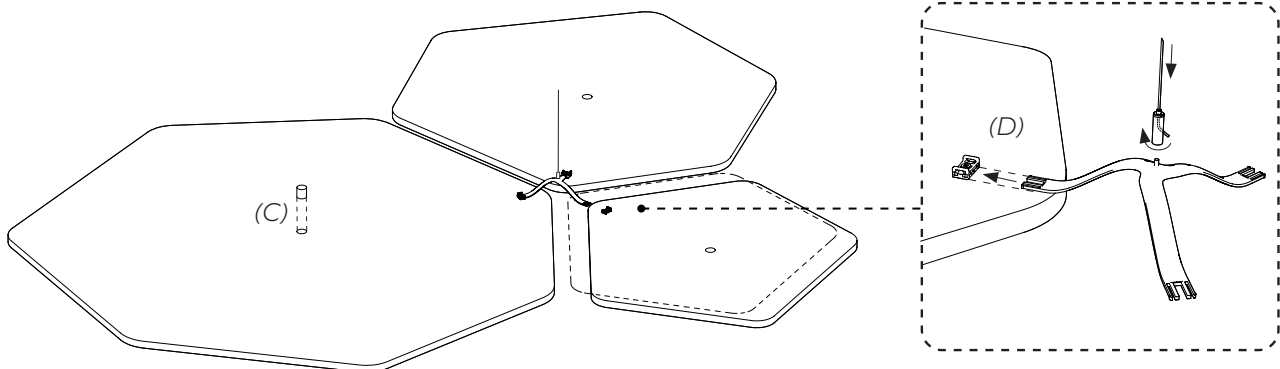
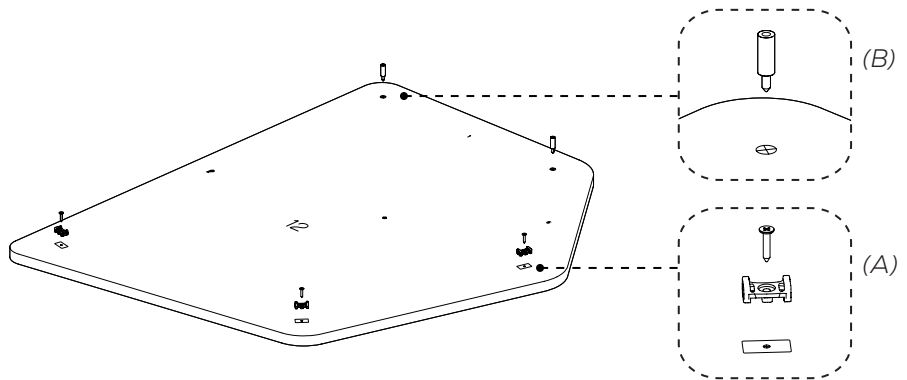

4 Install lights (optional)

Remove the central circular cut-out from the panels you wish to install the lights in (C). Push the spotlight into the opening and screw the driver to the panel.

5 Attach cables to the panels

Attach grippers with cables to the Tri/Bi Joints and slide them into the clips on the panels until the click (D). Continue attaching neighbor panels until complete.



Plateau Ceiling System

Optional Spot Lights

Each Plateau Archisonic PET ceiling panel is pre-cut with the central circular opening. The panel is not cut through entirely so the opening is not visible from the bottom side unless the cutout cilider is pushed out. We recommend performing a light analysis for your space in order to specify the right quantity and location of spot light elements.

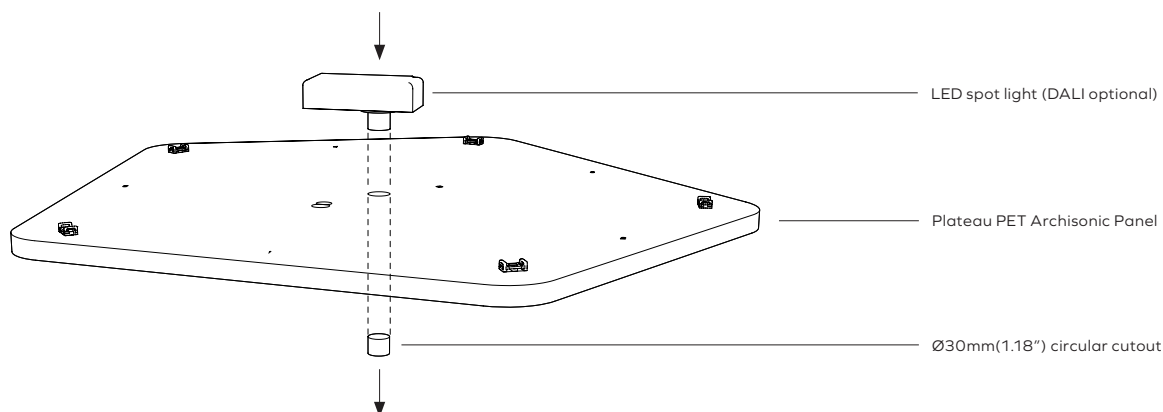

LIGHTING SPECIFICATIONS

per spot light

Output	Direct Only
Total Lumen Output (lm)	328
Wattage	6.5
Efficacy (lm/W)	50.5
Diffuser	Microprism
Beam Angle	34
CCT	2700-3000-3500-4000K
CRI	90+
MacAdam	3
Dimming (optional)	0-10V 0.1% DSI/DALI
Driver Location	On-Board

LIGHT DISTRIBUTION GRAPH

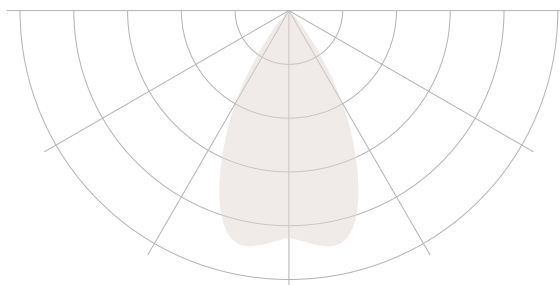

CERTIFICATIONS



ARCHISONIC®

Colors



Name	Snow White	Milk	Cloud	Smoke	Ground	Charcoal	Slate	Raven
Color Code	500	404	103	442	108	542	444	550
NCS Code	S 0300-N	S 0502-Y	S 1002-B	S 3005-R80B	S 5005-Y20R	S 7502-B	S 4500-N	S 8500-N
Name	Nordic Pine	Grove	Moss	Spearmint	Ice Blue	Succulent	Deep Sea	Marine Blue
Color Code	311	317	439	706	304	712	918	864
NCS Code	S 5030-G10Y	S 7020-G30Y	S 2040-G40Y	S 1010-B90G	S 0510-B	S 3020-B30G	S 5020-R90B	S 4050-R70B
Name	Linen	Shell Pink	Jute	Warm Stone	Terracotta	Soft Coral	Honeycomb	Sunshine
Color Code	107	102	920	105	239	516	139	846
NCS Code	S 1505-Y30R	S 0510-R30B	S 3010-Y30R	S 3010-Y50R	S 4040-Y70R	S 2020-Y90R	S 2050-Y20R	S 1040-Y10R
Name	Garnet	Hot Pink	Poster Red	Electric Orange	Winter Sky	Pacific Ocean	Midnight	Grape
Color Code	724	140	662	464	311	311	810	540
NCS Code	S 5040-R10B	S 2060-R20B	S 1080-R	S 0580-Y70R	S 5030-G10Y	S 5030-G10Y	S 7020-R70B	S 5040-R40B

These NCS codes are the closest visual match available and may not be exact to blended fibres.

ARCHISONIC®

Colors

Experience our ARCHISONIC® Felt material with a stunning selection of 32 colors across 8 distinct families, thoughtfully curated by *Colour Hive* in London. Effortlessly combine colors harmoniously to suit your preferences. Discover more in our Materials brochure and order your free sample box today.

Color fastness

Class 6

ISO 105-B02:A1

Order a free sample box



ARCHISONIC®

Material Specification

Product Name	Archisonic® Felt	
Content	100% PET (60% certified post-consumer content)	
Thickness¹	12mm (0.47")	24mm (0.94")
Max. Size	1200x2800mm (47"x110")	1800x2400mm (70"x94")
Acoustic²	ASTM: NRC=0.6 ISO: α_w =0.65	ASTM: NRC=0.9 ISO: α_w =0.95
Density¹	2400 g/m ² (0.49 lbs/ sqft)	4000 g/m ² (0.82 lbs/sqft)
Color Fastness	Class 6 ISO 105-B02:A1	
Color	32 colors (see Archisonic® Felt Color page for more information)	
Maintenance	For daily cleaning we recommend alcohol solution (75%), e.g. Pantasept. In case of contamination by dust or fluff, use feather duster or a regular vacuum cleaner. For heavy dirt, treat the material with hydrogen peroxide.	
Lead time³	21 days	
Fire Rating	DIN EN 13501-1: B-s1, d0	ASTM E84 Class A
VOC Emission	A+ 28 Days French Regulation	ASTM E84 Pass
Certifications	Declare label, Cradle to Cradle, UL Environmental Product Declaration, Member of US Green Building Council, Ecobau 1st Priority, Climate-KIC, VOC emissions in LEED EQ credit (low-emitting products), Breeam, SCS Recycled Content	
Durability	Contract	

1 - all values are nominal 2 - measured with 300mm air cavity 3 - depending on the location and type of product



Climate-KIC is supported by the EIT, a body of the European Union



Declare.



Plateau Ceiling System

Acoustic Performance



Testing Standards

ISO 354:2003	Acoustics — Measurement of sound absorption in a reverberation room
ISO 11654:1997	Acoustics — Sound absorbers for use in buildings — Rating of sound absorption
ISO 20189:2018	Acoustics — Screens, furniture and single objects intended for interior use — Rating of sound absorption and sound reduction of elements based on laboratory measurements
ASTM C423-17	Standard Test Method for Sound Absorption and Sound Absorption Coefficients by the Reverberation Room Method
ASTM E795-16	Standard Practices for Mounting Test Specimens During Sound Absorption Tests

Acoustic Test Results ISO

Frequency (Hz)		125	250	500	1000	2000	4000
Plateau Ceiling Panels 24mm PET	m ²	1.66	2.92	3.76	5.44	6.18	6.70

Acoustic Test Results ASTM (Sabins)

Frequency (Hz)		125	250	500	1000	2000	4000
Plateau Ceiling Panels 24mm PET	m ²	17.9	31.4	40.5	58.6	66.5	72.1

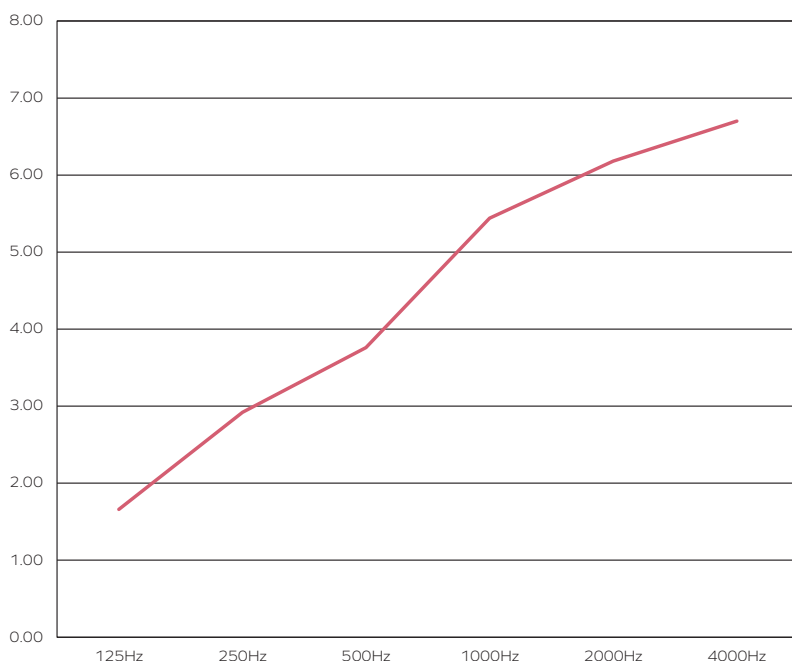

“If you want to control room acoustics from the ceiling, keep one important principle in mind: size matters.”

– Daniel Verlooven,
Global Acoustic Ambassador

● Plateau Ceiling Panels 24mm

The graph represents the sound absorption coefficients (α) in the third octave band center frequencies. Measurement used Pink Noise as excitation signal in a reverberant room.





HABITAT
MATTER

habitatmatter.com
spec@habitatmatter.com

Plateau Ceiling System

Reference Project

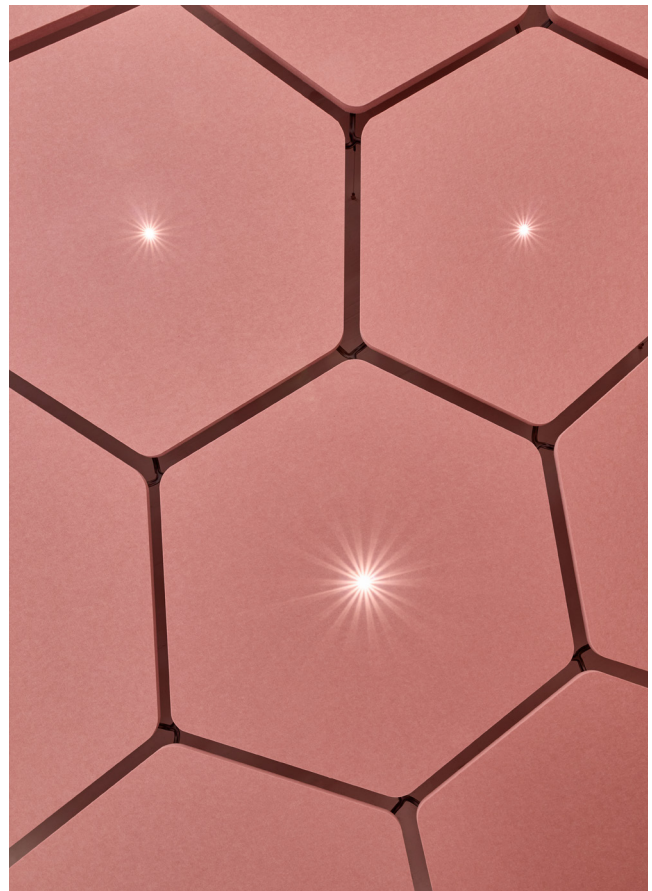

IMPACT ACOUSTIC®
Plateau Ceiling System rev.01 - 11.08.23

(Switzerland)
(USA)
(Philippines)

connect@impactacoustic.com
usa@impactacoustic.com
philippines@impactacoustic.com

(+41) 41 566 55 55
(+1) 646 918 1581
(+63) 285 80 02 50

#WeMakeAnImpact